

GTG-71/GTG-62 3HE Einbaumodul

Compact silicone keyboard, 71 or 62 keys, for front panel mounting and 3HE use.



Description



There are many different areas of application for this product. In order to make the installation into your own devices easier, the keyboard with PCB and integrated Controller is fit onto an aluminum front plate 3HE.

The device is ready for installation with AT interface. The GTG-62 is additionally available with RS232 interface.

The versions GTG-71 and GTG-62 differ in the keyboard layout. Please also see the data sheets "GTG-71 silicone mat" and "GTG-62 silicone mat" in the catalog cross reference.

You also find the description of the general advantages of the GTG-71 series and the GTG-62 series in the catalog cross references down below.

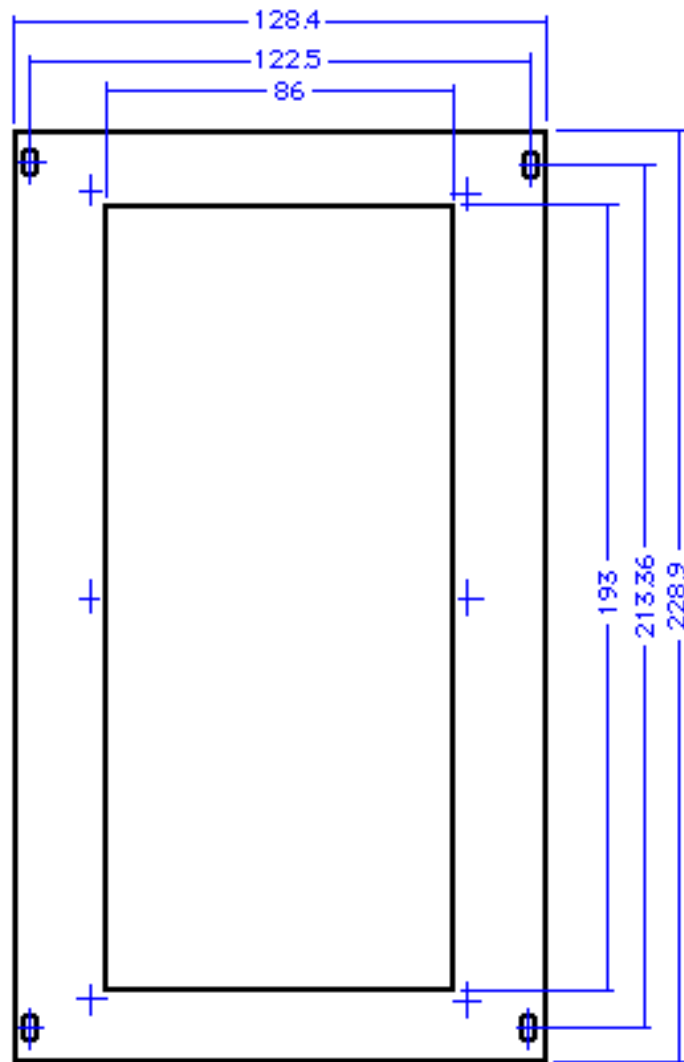
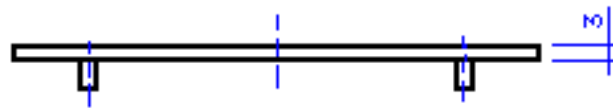



Specification

Mechanical data

Dimensions:	229 or x 128,4 or x x 22 or x mm
Weight:	0,360 kg or kg
Degree of Protection:	IP65
Housing:	Metal
Degree of Protection:	
Housing:	
Color:	
Cable Length:	cm

Keys

Key Technology:	conductiv rubber or
Number of Keys:	62 & 71 or
Keyboard Layout:	MF2-German or
Operational Life:	5 mio. keystrokes min. or 5 mio. keystrokes min. or mio. keystrokes min.
Stroke Force:	1,3 or \pm N
Stroke Travel:	1,2 or \pm mm
Key Legend:	silk screen or

Electric Data

Interface:	PS/2 & AT & serial or (with adapter)
Additional Interface:	(with adapter) for scanner for Touchpad for Trackball for mouse
Operating Voltage:	5 or \pm V
Operating Current:	110 \pm mA

Environment

Operating Temperature: from -10 °C or from °C to +60 °C or to °C

Storage Temperature: from -20 °C or from °C to +80 °C or to °C

Humidity:

Additional Information

Order Information

Order No.	Article	
KM1129	GTG-71-3HE-PS2-GER	PS/2 interfaces, german layout
KM1128	GTG-71-3HE-PS2-US	PS/2 interface, US layout
KM1136	GTG-62-3HE-PS2-GER	PS/2 interfaces, german layout
KM1137	GTG-62-3HE-PS2-US	PS/2 interface, US layout
KM1020	GTG-62-3HE-RS232-GER	RS232 interfaces, german layout
KM1021	GTG-62-3HE-RS232-US	RS232 interfaces, US layout

Accessories

Order No.	Article	
ZK1029	COM 9255 	adapter PS/2 to AT
ZK1011	GKA-182-AT	AT cable, 80cm
ZK1210	GKA-195-PS2	PS/2 cable, 180cm

Links

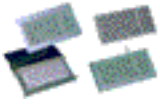
Click!	Titel
	GTG-71/GTG-62 Series Silicone mat keyboard with 71 or 62 keys in many different designs

sales@www.tastaturen.com Anrufen: (0 89) 89 43 99-0 Faxen: (0 89) 89 43 99-11